

1	Date	Revisions	Staff
	****	*****	**

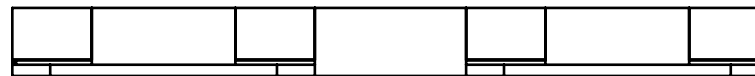
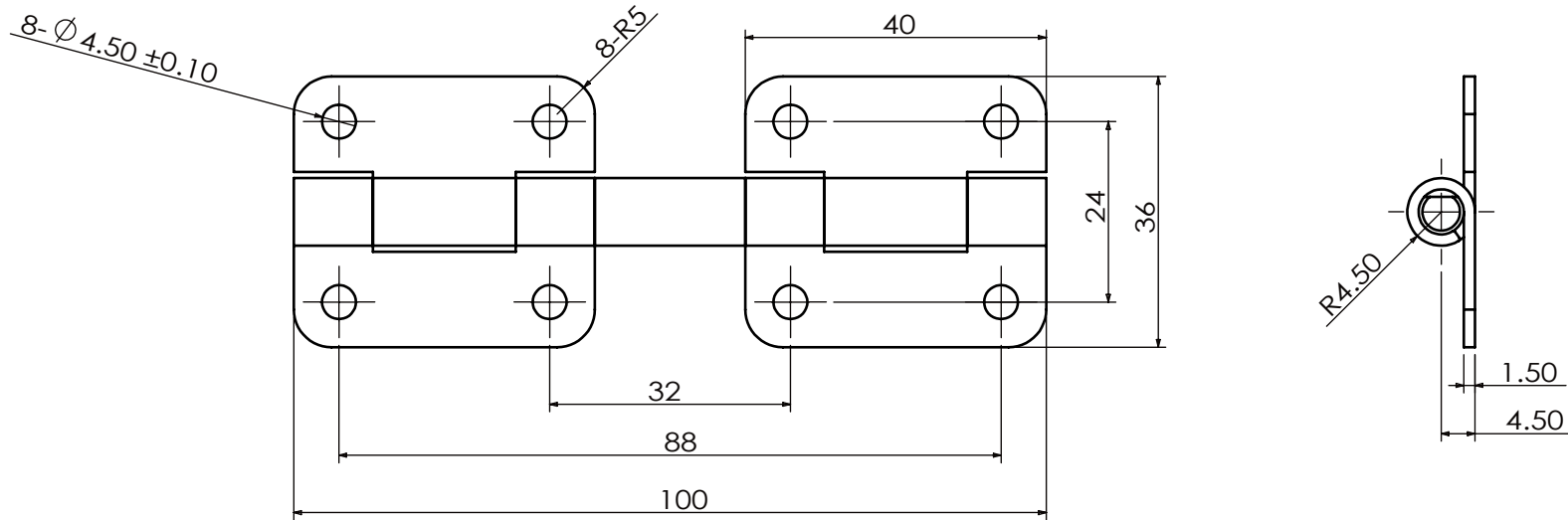

- 注:1.扭力:
 2.带圆圈尺寸为重点尺寸.
 3.表面镀无化学镍3~6μm
 4.倒角均为:C0.5
 5.一般公差:±0.2.
 6.使用产品必须符合ROHS要求。

001	组装图			****	****	1	
No.	Parts Name			Materials	Treat	Q'ty	Remarks
Approved	Checked	Drawn	Designed	Date	Tolerance	Customer	
				2019.5.26	L < 1 0.05		
				Scale	Angle	1 ≤ L ≤ 4 0.1	DWG Name
				1:1	* o 4 < L ≤ 16 0.15	*****	
Jiaxing yujia Machinery Co.,Ltd					Unit	mm	DWG No.
					16 < L ≤ 63 0.2	63 < L 0.25	SD2192A100000